

EUROCITIES Social Affairs Forum, Brussels, 27–28 March 2012



THE FUNCTIONAL HOME

- Information centre and exhibition on solutions, technology, aids and products for accessible and safe housing
- Social Services Department of the City of Helsinki

BIRTH OF THE FUNCTIONAL HOME

- project planning by the Social Services and Health Department in 1995–1998
- project implementation by the Social Services and Health Department in 1998–2000
- part of the City of Helsinki's permanent operations since 2000
- 4 employees: - exhibition director
- 3 exhibition coordinators

CORPORATE CO-OPERATION



- an average of 60–70 companies per year
- annual contract negotiated by the exhibition director
- exhibition designed and realised together
- changing topical themes
- company-owned products

The Functional Home's corporate partners in 2012

Kitchen Ferrules and mechanisms	Bathroom	Furniture Light fittings	Floors Textiles	Technology Safety	Rehabilitation and other aids Care equipment Clothing	Security and care services
Electrolux	Tamsale	Ergotekniikka	Finlayson	Abloy	Algol-Trehab	Esperi Care
Franke	Electrolux	Innojok	Hanna Korvela	Diaconia University of Applied Sciences	Bedpal	Mainiovire
Hahle	Geberit	Kinnarps		Arcti-Care	Aviris	Palmia
Hettich	Duuri	Kiteen Huonekalutehdas	RTV-Yhtymä	Audience First	EN-Apuvälineet	
Häfele	IDO	Kontiopuu	Svensson Markspelle	AngloNordic/DORO	FennoMedical	
Keittiötieto	Mediq Suomi	Liune/Aulis Lundell		AMO/Nintendo	HUR	
Kontio-Keittiöt	Oras	Martela		Havainne	KL-Support	
Oras	Respecta	Ettonet		Kajo Apuvälineet	Lojer	
Savo	RTV-Yhtymä			Linak	Suomen Apu- Tuote	
Stala	Väinö Korpinen			MariMils	MediWe	
Suomen Apu-Tuote				Insmat	Mediq Suomi	
Variante				Robokeskus	PT-keskus	
				Menumat	Respecta	
				Suomen Fysioakustiikka	Stieglmeyer	
				STT Condigi	Hissipörssi	
				Tunstall	Kontutek	
				Vaios	Pro-Hewa	
				Wiktio		

KEY FIGURES

- Budget: EUR 300 000
- Consists of:
 - the City of Helsinki
 - corporate contracts
 - guided groups
 - training





WORLD DESIGN
CAPITAL
HELSINKI 2012

- The Functional Home – innovative and safe housing solutions
- as part of the WDC Helsinki 2012 programme, the Functional Home presents, among other things, the following:
 - the latest technology
 - home robotics
 - solutions by Finnish designers

The exhibition area is approximately 300 m², which includes two show flats, one lecture room and exhibition rooms.

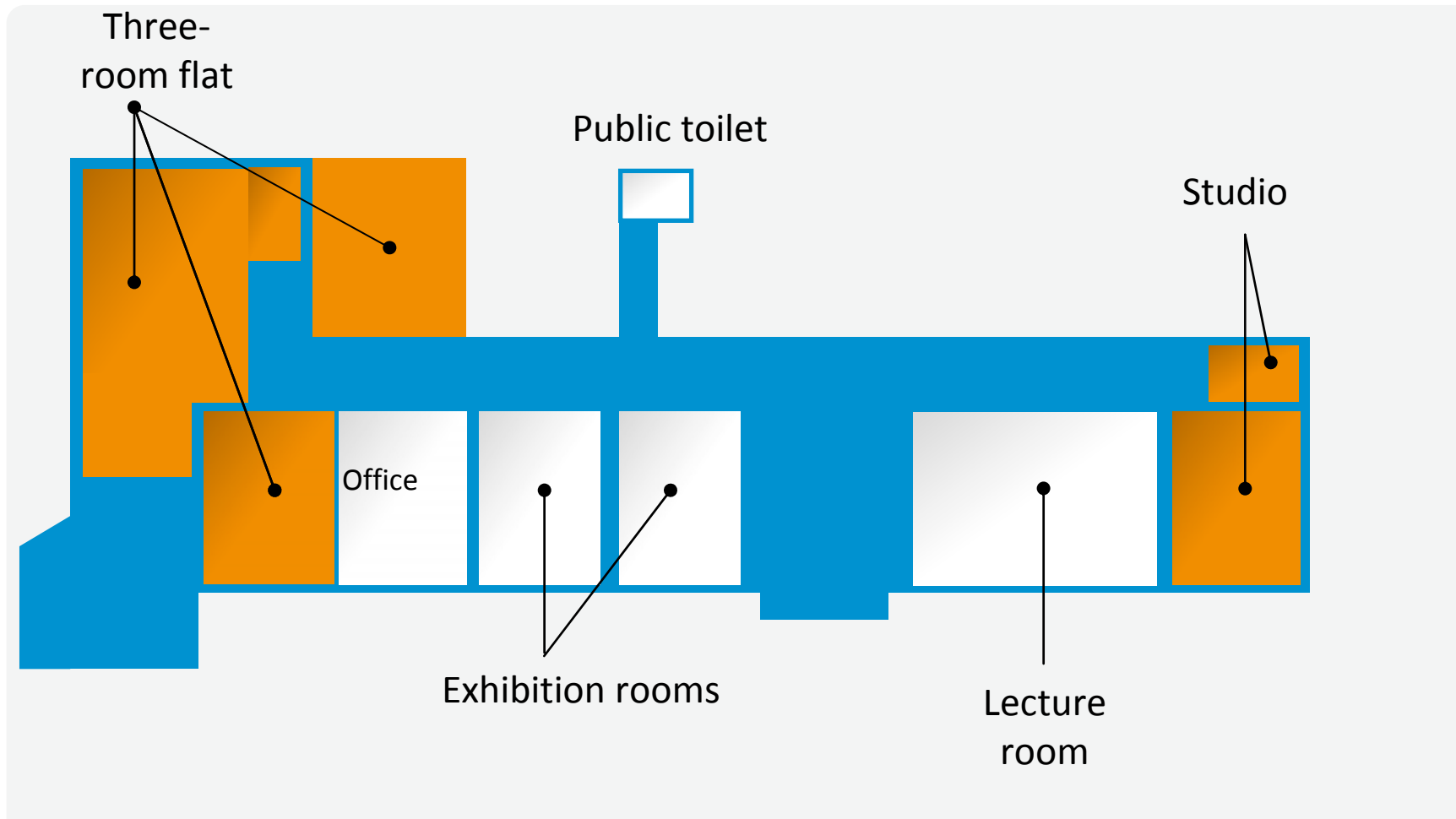

OPERATING IDEA

- a low-threshold facility where you can come to find ideas for functional everyday life and try out products yourself
- an unbiased party offering information about available products and solutions and their acquisition processes, locations and costs
- offers public, private and third sector service providers the opportunity to establish networks and design new services

CLIENTS

- everybody interested in the accessibility, functioning and safety of homes
- the elderly
- people with physical disabilities
- family caregivers
- professionals and students in the field of social and health care
- professionals and students in the field of construction and design
- decision-makers and project groups

SERVICES

- guided tours for groups
- guidance for individual clients
- advice by telephone and e-mail
- guidance for purchasing aids and starting alteration work in a flat
- training and events (e.g., public lectures, family caregivers' meetings, training for professionals)
- distributing information via the www.toimivakoti.fi website

OTHER ACTIVITIES

- co-operation with various city departments
- co-operation with the third sector
- lecturers and expert services
- fairs
- seminars